

**Basic socket series designation for:**  
Series YCA

**Designed to the standards and requirements of:**  
MIL-DTL-12883/46

## SOCKET DRAWING

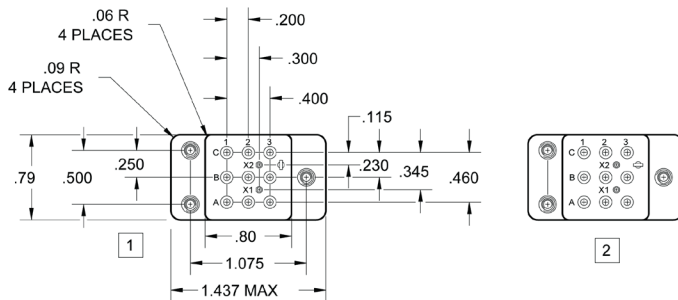

## HARDWARE MOUNTING

### MOUNTING DETAIL 3 PLACES

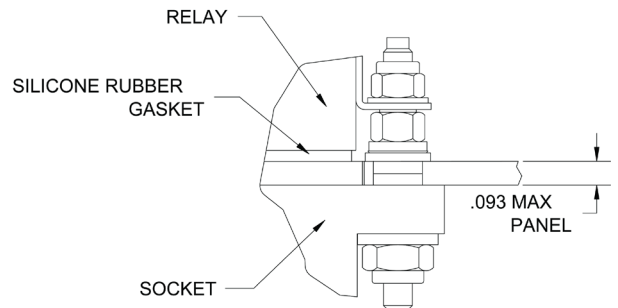

## MOUNTING DIMENSIONS

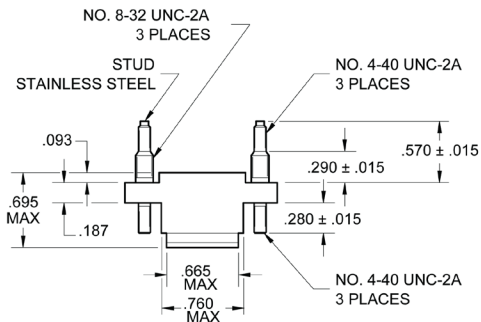

BOTTOM MOUNT-CLEARANCE  
HOLE FOR .164 SCREW  
TOP MOUNT-CLEARANCE  
HOLE FOR .112 SCREW

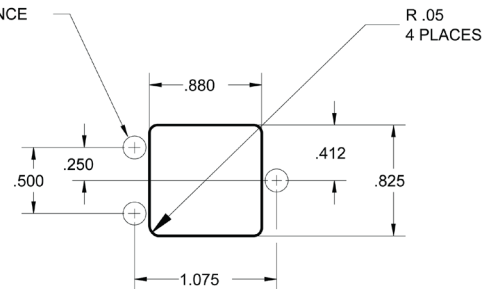

## GENERAL CHARACTERISTICS

1. Supplied with mounting hardware and No. 16 contacts and crimp for power terminals; No. 20 contacts and crimp for coil terminals (SO-1065-10392).

2. Supplied with mounting hardware and No. 16 contacts and crimp for power terminals; No. 20 contacts and crimp for coil terminals (SO-1065-10393).

3. Standard tolerances

.xx ± .01; xxx ± .005

4. Weight

.052 lbs. max

5. Operating temperature

-70° C to +125° C